

# TECHNICAL GUIDE

# GRASSMAT



*GrassMat, the accessibility and protection mat for lawns*

## SUMMARY

General Characteristics	02
Product accessories	02
Applications and installation conditions	03
Resistance tests	05
Warranty	05
References	05

# GENERAL CHARACTERISTICS

## 2 SOLUTIONS / 2 TYPES OF USE

**Grassmat 1.6 kg / sqm :** Economic solution, ideal for pedestrian use or light vehicles (<3.5 tons).

**Grassmat 2kg / sqm :** Ideal for intensive use for light vehicles (<3.5 tonnes) or for the passage of heavy vehicles (up to 10 tons)

## DIMENSIONS / TECHNICAL INFORMATION :

**2 available widths :** • 1m • 2m

**Length :** Rolls up to 20 meters long (connectable). We adapt to your configuration and customize the length of the mat on request.

**Thickness :** 14,5 mm

**2 Weights :** 1,6 kg/sqm et 2kg /sqm

**Colour :** Green

**Materials :** 100% Polyethylene mesh

## ADVANTAGES :

- Anti-slip
- Prevents entanglement on wet or unstable surfaces
- Does not retain heat from the sun, UV resistant
- Quick installation, maintenance and uninstallation
- Allows grass to grow between the meshes
- Made of recycled and recyclable polyethylene

# PRODUCT ACCESSORIES

## Fixation :

U-fixing system (U-shaped mounting) are provided to facilitate the installation and fixing of the mat. They also make it easy to connect two mats. The height of the rider is 17cm.



## Straps :

Straps are provided to facilitate the transport of the mat. Two straps will accompany each of your mat. They can also make it easier to store your mat at the end of the season if you want to remove them.

# APPLICATION AND INSTALLATION CONDITIONS

Ideal for use on grass, the GrassMat mat provides access to your green spaces. It is recommended to use GrassMat during periods of high turf growth. Seeding can take place after the GrassMat has been installed.

## REQUIRED EQUIPMENT :

- Hammer

Two people can install a 40 meters section in just 10 minutes.

## INSTALLATION / THE DIFFERENT STAGES :

### Step 1 : Leveling the ground

Fill the soil defects with sand or soil.

On the lawn, unroll the mat at the desired location (a broom is sufficient to defoliate the soil if necessary). It is recommended to temporarily attach it to the 4 corners so that the mat returns to its flat appearance (delivered in rolls). The recommended waiting time is about 1 hour and may vary depending on the weather.

It is advisable to install the Grassmat on mown grass.

### Step 2 : Fixing the mats to the floor

After unwinding your mat in the intended location, it is simply necessary to fix your mat using a hammer to drive the U-fixing system into the mesh at the desired location (**5 U-Fixing system are provided for each square meter ordered**). It is recommended to fix between the upper meshes of the GrassMat so that the rafters do not protrude. We recommend to put the U-fixing system according to the following diagram:

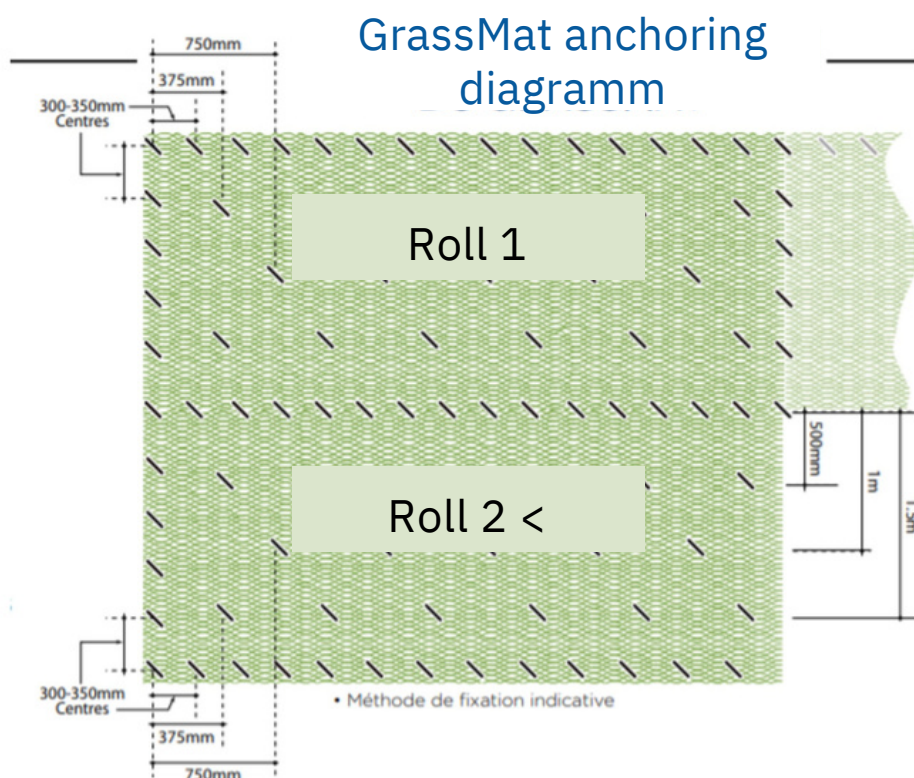

**NB :**

**Thermal expansion and contraction in hot climates:**

It is recommended to leave a spacing of 15mm between each roller before fixing.



**POOR FIXING OF THE U-PIN**



**CORRECT FIXING OF THE U-PIN**

#### PRECAUTIONS TO TAKE :

##### METHOD OF FIXING THE JUMPERS:

**MAKE SURE TO INSERT THE JUMPERS IN THE GROOVES OF THE GRASSMAT TO LIMIT ANY DISCOMFORT.**

### Step 3: Help with the growth of the grass

When the GrassMat is in place, it is advisable to water or spread fertilizer so that the grass grows and restores a natural appearance to the surface. The best results are obtained by prohibiting the passage of vehicles until the lawn has grown through the GrassMat.

NB: Thermal expansion and contraction in hot climates: It is recommended to leave a 15mm gap between each roll before fixing.

## MAINTENANCE

GrassMat can be cleaned quickly with a broom, blower or pressurized water jet. The first 3 or 4 mowings must be made with a higher cutting blade to allow the grass to develop properly.

## UNINSTALL / THE DIFFERENT STAGES :

### **Step 1 : Remove the piles**

If the U-fixing systems are firmly anchored, it may be necessary to use a clamp.

### **Step 2 : Roll up the mat**

All you have to do is roll up your mat and use the transport strap for handling and storage.

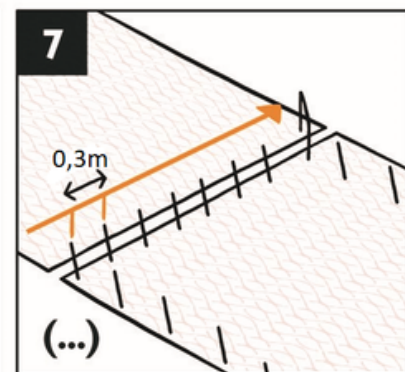
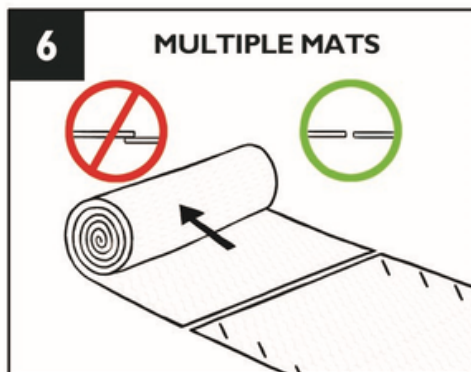
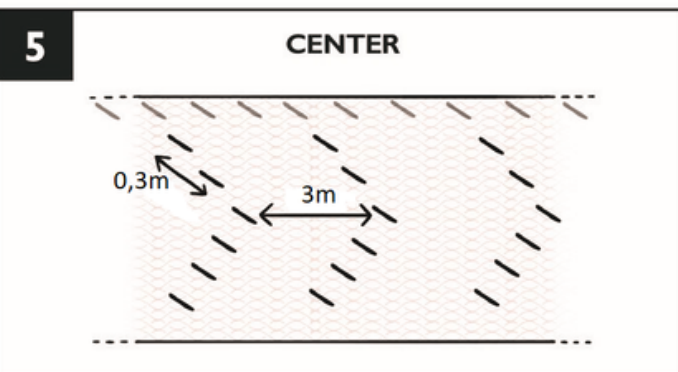
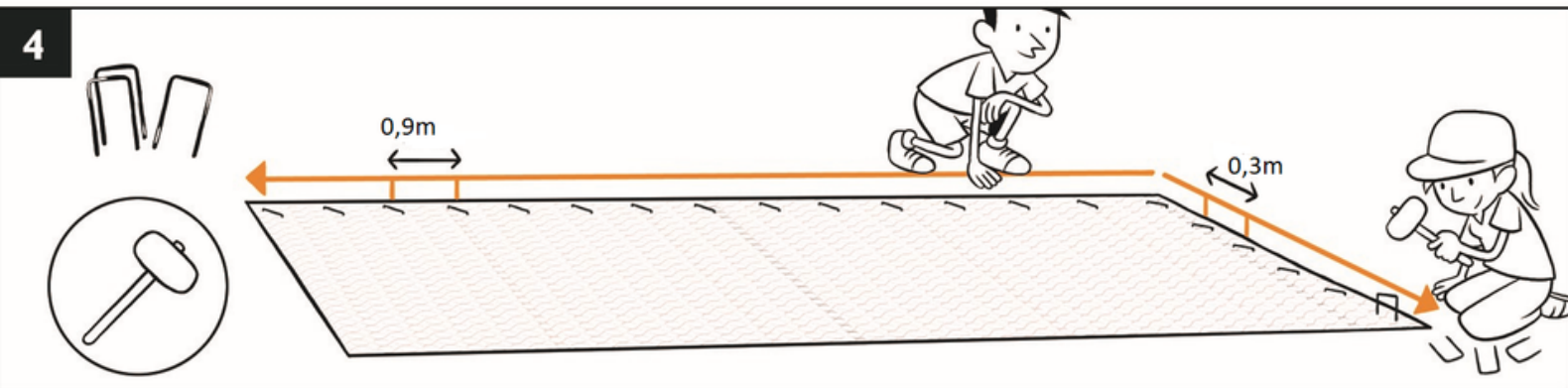
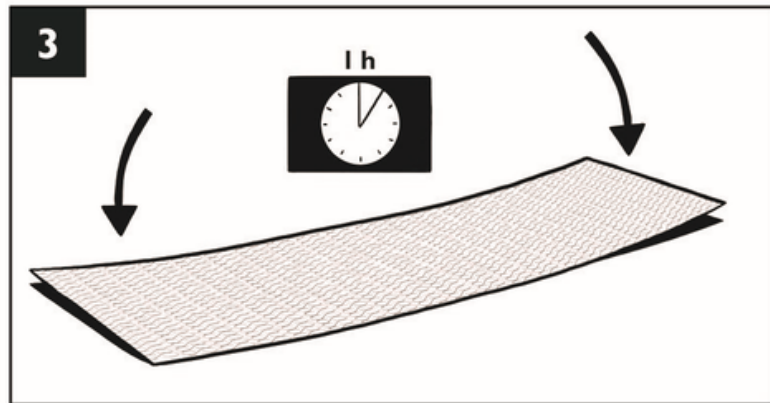
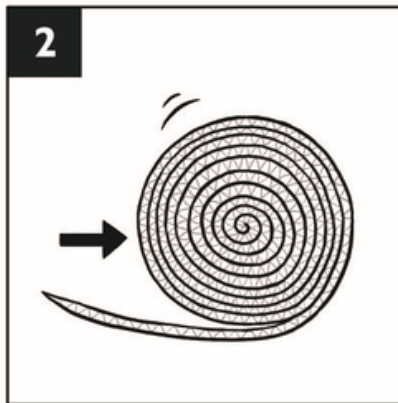
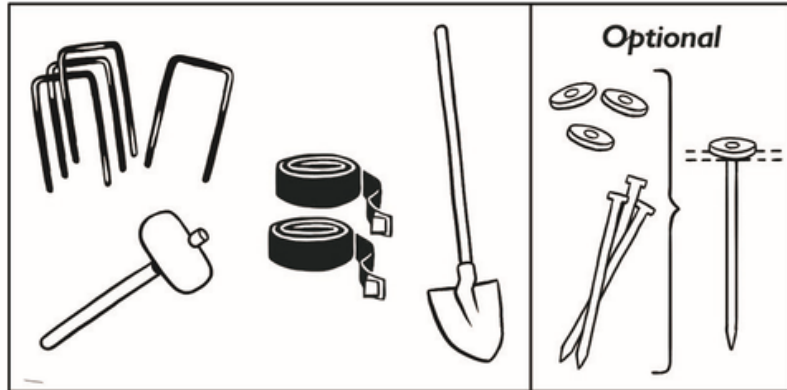
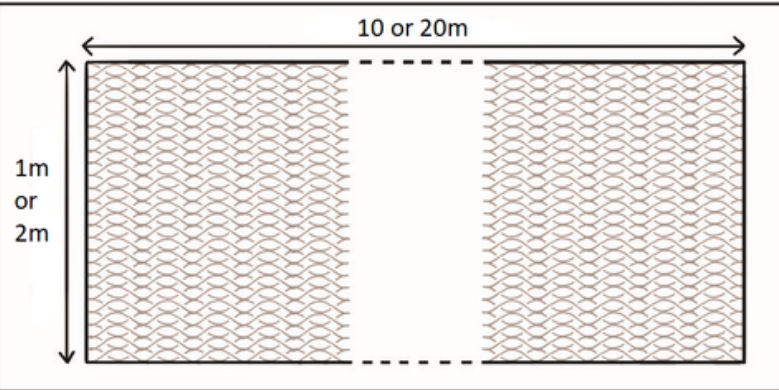

# RESISTANCE TESTS

<b>Tensile strength (MD) in ISO 10319:</b>	<b>14 kN/m</b>
<b>Elongation at maximum load (MD) in ISO 10319:</b>	<b>35%.</b>
<b>Residual thickness@ 500kPa in ASTM D1621:</b>	<b>80%.</b>
<b>PTB value of slip risk (average) in BS7973 1-3 :</b>	<b>&gt;40 (low)</b>

# WARRANTY

***Accessrec Europe offers a two (2) year limited warranty from the date of purchase. This warranty only covers manufacturing defects of the product. Alterations due to normal use are not considered as manufacturing defects. Damage caused by vandalism or passing vehicles (other than those intended for normal use of the product) is not covered by the warranty.***

The warranty does not apply to:

- Normal wear and tear on solutions
- Misuse, maintenance or storage of the solution.
- An accident or natural disaster
- Changes that have been made to the solution without the written consent of Accessrec Europe.
- Repairs that have been made without the written consent of Accessrec Europe.
- Labour or shipping costs that may be necessary if repairs are being considered.

If you are not satisfied with the conditions or repairs that have been made, please contact Accessrec Europe directly. Products may not be returned without the consent of Accessrec Europe. The two (2) year warranty is only applicable to the original purchaser.

# RÉFÉRENCES



The head office, Apple – Californie, USA



Museum of Fine Arts, Caen